

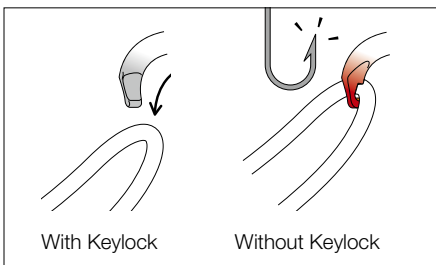

© Petzl - vuedici.org

To simplify connection and disconnection, Petzl connectors have features that simplify their use.



#### Avoids the risk of snagging

To ensure optimal efficiency, all Petzl carabiners use the Keylock system: the body/gate interface does not have a hook that could snag on anchors, ropes, harness equipment loops...

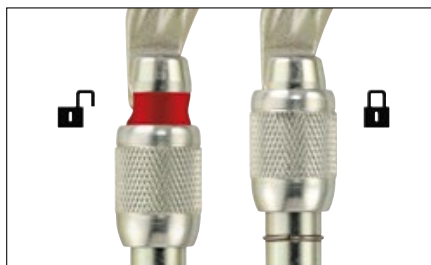

#### Visual locking indicator

To facilitate equipment checks, SCREW-LOCK manual locking carabiners have a red band that is visible only when the carabiner is not locked.

### Lightweight carabiners

Aluminum carabiners designed for workers at height.

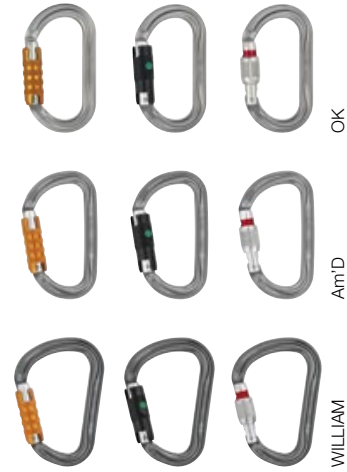

### Ultra-lightweight carabiners

Compact aluminum carabiners for workers at height looking to reduce weight to a minimum.



### High-strength carabiners

Steel carabiners suitable for difficult environments, primarily used for setting up anchors and for connecting to metal structures.



### Lanyard-end connectors

Connectors designed for lanyard ends.



### Special carabiners

Aluminum carabiners designed for specific uses: with groups, at the end of a lanyard, for additional braking with a descender, and for harness fastening.



### Semi-permanent connectors

Connectors designed for semi-permanent connection of equipment.



### Connector positioning accessories

Accessories that keep the carabiner correctly positioned in devices and at the end of a lanyard.



Lightweight carabiners

• Design facilitates handling

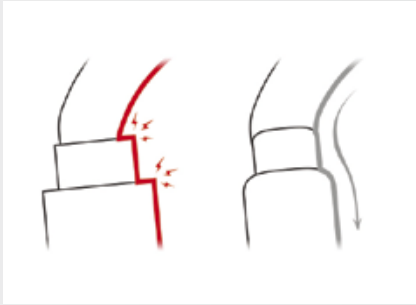

**Fluid interior design**

Fluid interior design limits the risk of having a catch point and facilitates rotation of the carabiner.

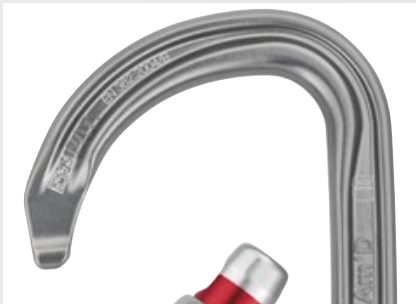

**Optimal strength/weight ratio**

The H cross-section ensures an optimal strength/weight ratio and protects the markings from abrasion.

• Multiple locking systems depending on the intensity of use:

- for frequent handling:

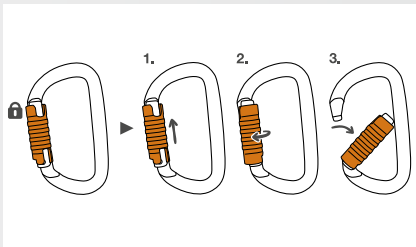

**TRIACT-LOCK automatic system:**

Unlocking is accomplished by raising, then turning the sleeve.

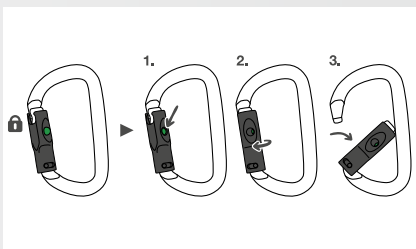

**BALL-LOCK automatic system:**

Unlocking is accomplished by pressing on the green indicator, then turning the sleeve. The green visual indicator is visible only when the gate is locked.

- for occasional handling:

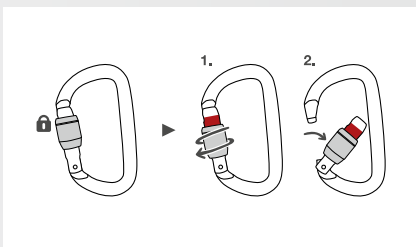

**SCREW-LOCK manual system:**

This system is suitable for harsh environments where contaminants (mud, ice) could cause an automatic locking system to jam. The red visual indicator is visible when the carabiner is unlocked.

• For connecting to equipment having a large cross-section



The OK carabiner has a symmetrical oval shape for optimal loading of devices with a large cross-section, such as pulleys, rope clamps or mobile fall arresters.

• For connection to equipment such as descenders or positioning lanyards



The Am'D carabiner has an asymmetric D shape that is ideal for attaching equipment such as descenders or positioning lanyards.

• For connection of multiple items



The WILLIAM has an asymmetric pear shape, with a large capacity for attaching multiple elements, and a large gate opening to facilitate their installation.



## OK

### Lightweight oval carabiner

The lightweight OK carabiner is made of aluminum. It has an oval shape that allows optimal loading of devices with a large cross-section, such as pulleys, rope clamps, and mobile fall arresters. The fluid interior design and Keylock system facilitate handling. It is available in three locking systems: automatic TRIACT-LOCK or BALL-LOCK, or the manual SCREW-LOCK. OK can be connected to the CAPTIV bar to favor positioning of the carabiner along the major axis, to limit the risk of it flipping and to keep it integrated with the device.



## Am'D

### Lightweight asymmetrical carabiner

The Am'D lightweight asymmetrical carabiner is made of aluminum. It has a D shape particularly suited for connection to diverse equipment such as descenders or positioning lanyards. The fluid interior design and Keylock system facilitate handling. The Am'D carabiner is available in three locking systems: automatic TRIACT-LOCK or BALL-LOCK system, or the manual SCREW-LOCK system. Am'D may be used with a CAPTIV positioning bar to favor loading of the carabiner along the major axis, to limit the risk of it flipping and to keep it integrated with the device.



## WILLIAM

### Lightweight asymmetrical large-capacity carabiner

The lightweight WILLIAM large-capacity asymmetrical carabiner is made of aluminum. It has a pear shape that is practical for easily connecting multiple items. The fluid interior design and Keylock system facilitate handling. The WILLIAM carabiner is available in three locking systems: automatic TRIACT-LOCK or BALL-LOCK, or the manual SCREW-LOCK. WILLIAM can be used with the CAPTIV bar to favor positioning of the carabiner along the major axis, to limit the risk of it flipping and to keep it integrated with the device.



## Ultra-lightweight carabiners



## Sm'D

**Ultra-lightweight asymmetrical carabiner**

The compact Sm'D asymmetrical aluminum carabiner is recommended for workers at height looking to reduce weight to a minimum. D shape makes it especially suitable for attaching devices. It is available in two locking systems (automatic TRIACT-LOCK system or manual SCREW-LOCK system), or without a locking system.

## High-strength carabiners

CAPTIV  
COMPATIBLE

## OXAN

**High-strength oval carabiner**

OXAN is a high-strength steel carabiner designed for use in difficult environments. The oval, symmetrical shape allows optimal loading of the carabiner when setting up anchors or connecting to metal structures. It is available in two locking systems: automatic TRIACT-LOCK system or manual SCREW-LOCK system. OXAN TRIACT-LOCK is available in European or international versions. OXAN can be combined with the CAPTIV bar to favor positioning of the carabiner along the major axis, to limit the risk of it flipping and to keep it integrated with the device.



The oval, symmetrical shape allows optimal loading of the carabiner when setting up anchors. Usage with the CAPTIV positioning bar favors loading of the carabiner along the major axis, limits flipping and keeps it attached to the device or lanyard.



## VULCAN

**High-strength asymmetrical carabiner with large capacity**

VULCAN is a high-strength steel carabiner designed for use in harsh environments. The large-capacity asymmetrical shape is ideal for setting multiple anchors. The VULCAN carabiner is available in two locking systems: automatic TRIACT-LOCK system or manual SCREW-LOCK system. VULCAN TRIACT-LOCK is available in European or international versions.

NEW  
2019CAPTIV  
COMPATIBLE

## Bm'D

**Lightweight asymmetrical high-strength carabiner**

The Bm'D lightweight asymmetrical carabiner is made of aluminum. It has a D shape particularly suited for connection to diverse equipment such as descenders or positioning lanyards. The fluid interior design and Keylock system facilitate handling. The Bm'D carabiner has the TRIACT-LOCK automatic locking system. The sleeve is reinforced for greater front and lateral gate strength. Bm'D may be used with a CAPTIV positioning bar to favor loading of the carabiner along the major axis, to limit the risk of it flipping and to keep it integrated with the device.

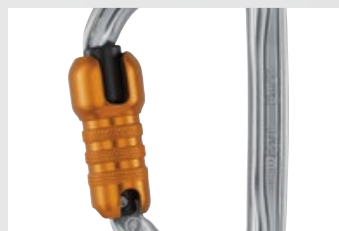

The sleeve is reinforced for greater front and lateral gate strength.

## Lanyard-end connectors



## VERTIGO TWIST-LOCK

**Carabiner for progression lanyard**

The VERTIGO TWIST-LOCK carabiner is designed for use on progression lanyards. The excellent grip and automatic locking system facilitate handling when passing intermediate anchors. The wide opening and the Keylock system allow the carabiner to be easily connected.



## EASHOOK OPEN

**Carabiner with gated connection point for double lanyard and work positioning lanyard**

The EASHOOK OPEN carabiner is designed for use at the ends of a double lanyard or work positioning lanyard. The gated connection point allows for direct attachment of the carabiner to the lanyards. If the lanyard is damaged, the connector can thus be reused. The excellent grip and automatic locking system facilitate handling when passing intermediate anchors.



## MGO OPEN 60

**Auto-locking directional connector with large gate opening, and a gated connection point**

MGO OPEN is an auto-locking directional connector with a large gate opening for connection to metal structures or to large-diameter cables and bars. It has a gated connection point for attachment to different types of lanyards. If the lanyard is damaged, the connector can thus be reused.



## MGO 110

**Auto-locking directional connector with very large gate opening**

MGO 110 is an auto-locking directional connector with very large gate opening for connection to metal structures or to very large-diameter cables and bars.

## Special carabiners



## Am'D PIN-LOCK

**Asymmetrical aluminum carabiner, unlocks with a tool**

The Am'D PIN-LOCK asymmetrical aluminum carabiner is designed for use with groups. It secures the connection of the user thanks to its PIN-LOCK system, which can only be opened by the operator with a specific unlocking tool. Am'D PIN-LOCK may be used with a CAPTIV positioning bar to favor loading of the carabiner along the major axis, to limit the risk of it flipping and to keep it integrated with the device.



## FREINO

**Carabiner with friction spur for descenders**

The FREINO is ideal for adding or adjusting friction during the descent.



## OMNI

**Multidirectional semi-circle carabiner**

Multidirectional semi-circle OMNI carabiner for fastening the FALCON ASCENT harness and for attaching a CROLL ventral rope clamp. It is available in two locking systems: automatic TRIACT-LOCK system or manual SCREW-LOCK system.



## Semi-permanent connectors



## RING OPEN

**Multidirectional gated ring**

The RING OPEN gated ring is designed for the semi-permanent connection of equipment. Round shape ensures optimal functioning in all directions. It has a large opening that allows installation of ropes with sewn terminations.



## DELTA

**Triangular steel quick link**

When closed with a wrench, this steel quick link becomes a semi-permanent anchor ring.



## GO

**Oval steel quick link**

When closed with a wrench, this steel quick link becomes a semi-permanent anchor ring.



## DEMI ROND

**Semi-circle aluminum alloy quick link**

When closed with a wrench, this aluminum quick link is used to fasten harnesses that have two attachment points that must be joined with a connector.

## Connector positioning accessories



## CAPTIV

**Connector positioning bar (pack of 10)**

The CAPTIV positioning bar promotes loading of the carabiner on the major axis, limits the risk of rotation and keeps it integrated with the device or lanyard. CAPTIV is compatible with OK, Am'D, Am'D PIN-LOCK, WILLIAM, OXAN, Bm'D carabiners and the ROLLCLIP A pulley carabiner.



Used with the I'D descender, the CAPTIV connector positioning bar limits the risk of flipping the carabiner and integrates it with the device.



## TANGA

**Connector positioning ring (pack of 10)**







The TANGA positioning ring helps hold the connector in the correct position.

NEW  
2019

## STRING

**Accessory for maintaining connector orientation and protecting carabiner attachment loop (pack of 10)**

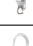
STRING helps maintain the proper orientation of the connector and protects the carabiner attachment loop from wear. It is available in two sizes.

Locking		References					Certifications	Weight	
<b>Lightweight carabiners</b>									
OK		TRIACT-LOCK	M33A TL / TLN (1)	22 mm	25 kN	8 kN	7 kN	CE EN 362, EAC	75 g
		BALL-LOCK	M33A BL	23 mm					75 g
		SCREW-LOCK	M33A SL / SLN (1)	22 mm					70 g
Am'D		TRIACT-LOCK	M34A TL / TLN (1)	24 mm	27 kN	8 kN	7 kN	CE EN 362, EAC, NFPA 1983 Technical Use	75 g
		BALL-LOCK	M34A BL	25 mm					75 g
		SCREW-LOCK	M34A SL / SLN (1)	25 mm					70 g
WILLIAM		TRIACT-LOCK	M36A TL / TLN (1)	27 mm	27 kN	8 kN	8 kN	CE EN 362, EAC, NFPA 1983 Technical Use	90 g
		BALL-LOCK	M36A BL	27 mm					90 g
		SCREW-LOCK	M36A SL / SLN (1)	28 mm					85 g
<b>Ultra-lightweight carabiners</b>									
Sm'D		TRIACT-LOCK	M39A TL / TLN (1)	18 mm	23 kN	8 kN	7 kN	CE EN 362, CE EN 12275 type B, EAC	55 g
		SCREW-LOCK	M39A SL / SLN (1)	20 mm					45 g
		Non-locking	M39A S / SN (1)	23 mm					40 g
<b>High-strength carabiners</b>									
OXAN		TRIACT-LOCK European version	M72A TL	22 mm	38 kN	16 kN	15 kN	CE EN 362, EAC, NFPA 1983 Technical Use	195 g
		TRIACT-LOCK international version	M72A TLA / TLN (1)	20 mm					230 g
		SCREW-LOCK	M72A SL / SLN (1)	22 mm					185 g
VULCAN		TRIACT-LOCK European version	M73 TL	28 mm	40 kN	16 kN	11 kN	CE EN 362, EAC, NFPA 1983 General Use	285 g
		TRIACT-LOCK international version	M73 TLA / TLN (1)	27 mm					305 g
		SCREW-LOCK	M73 SL / SLN (1)	29 mm					265 g
<b>NEW 2019</b>		TRIACT-LOCK	M032AA00 / 01 (1)	18 mm	32 kN	16 kN	10 kN	CE EN 362, EAC, ANSI Z359.12, NFPA 1983 Technical Use, CSA Z259.12	105 g
<b>Lanyard-end connectors</b>									
VERTIGO TWIST-LOCK		TWIST-LOCK	M40A RLA	25 mm	25 kN	10 kN	8 kN	CE EN 362	100 g
EASHOOK OPEN		Automatic	M043AA00 / 01 (1)	25 mm	25 kN	-	10 kN	CE EN 362, EAC	160 g
MGO OPEN 60		Automatic	MGOO 60	63 mm	23 kN	-	23 kN	CE EN 362, EAC	490 g
MGO 110		Automatic	MGO 110	110 mm					940 g
<b>Special carabiners</b>									
Am'D PIN-LOCK		PIN-LOCK	M34A PL (x 1) M34AB PL (x 10)	25 mm	27 kN	8 kN	7 kN	CE EN 362, CE EN 12275, EAC	80 g
FREINO		TWIST-LOCK	M42	15 mm	25 kN	10 kN	9 kN	CE EN 362	85 g
OMNI		TRIACT-LOCK	M37 TL / M37TLN	22 mm	20 kN	15 kN	7 kN	CE EN 362	90 g
		SCREW-LOCK	M37 SL / M37SLN						85 g
<b>Semi-permanent connectors</b>									
RING OPEN		Gated ring	P28	11 mm	23 kN	23 kN	-	CE EN 362	70 g
DELTA		Quick link	P11	12 mm	25 kN	10 kN	-	CE EN 362 type Q	150 g
		Quick link	P11 8, P11 8B, P11 8BN (1)	10 mm					85/95 g
GO		Quick link	P15	16 mm					60 g
DEMI ROND		Quick link	P18	10 mm					55 g

(1) Black connectors

